



**Spraying Systems Co.**  
Experts in Spray Technology



# SPRAYING SYSTEMS CO. PANELSPRAY® SYSTEMS

PRECISE SPRAY APPLICATION FOR  
ENGINEERED WOOD PRODUCTS



[www.spray.com](http://www.spray.com)

AL · ENERGY · **ENGINEERED WOOD** · PAPER · PHARMA · **BUILDING MATERIALS** · STEEL · AUTOMOTIVE · CHEMICAL · ENERGY  
COOLING · **COATING** · DRYING · FIRE PROTECTION · **DUST CONTROL** · HUMIDIFICATION · **RELEASE AGENT** · MINING · TANK CLEANING  
· **SPRAY CONTROL** · TANK CLEANING · **AUTOMATED** · DISINFECTION · SPRAY LANCES · ACCESSORIES · **NOZZLES** · SPRAY GUNS



# PRECISE SPRAY APPLICATION FOR ENGINEERED WOOD PRODUCTS PANELSPRAY® SYSTEMS

- » *We reduce your glue consumption!*
- » *We reduce maintenance cost!*
- » *We spray PMDI glue, wx and paraffine*

## HOW OUR PANELSPRAY SYSTEMS WORK //

Suitable for use with both LPF and MDI resins, the PanelSpray® system with PSC achieves optimal resin coverage through precise control of the application rate based on chip throughput. Over-application of costly resin is eliminated.

PulsaJet® air atomizing nozzles produce very small drops in a tightly controlled pattern. The nozzles also feature a high turndown ratio so a wide range of flow rates are possible without any change in spray performance.

Closed-loop system control, provided by the AutoJet® Model 2850+ spray controller, automatically adjusts the flow rate to maintain a specific volume of resin per weight of chip throughput.

PanelSpray® offers precise, automated control and dependable performance with minimal downtime.

### APPLICATIONS



- Moisturizing
- Steel Belt Protection / Lubrication
- Release Agent / Biocide Protection
- Dust Suppression
- Glue Application

### IDEAL FOR MANUFACTURERS OF



- |   |  |
|---|--|
| <ul style="list-style-type: none"> <li>· OSB</li> <li>· MDF/HDF</li> <li>· Particleboard</li> <li>· Palets</li> </ul> | <ul style="list-style-type: none"> <li>· Biocide protection</li> <li>· Other engineered wood products</li> </ul> |
|---|--|

*Spraying Systems Co. is the  
BIGGEST producer of nozzles  
and spray systems worldwide!*



**RELEASE AGENT WITH MOISTURIZING  
MAT SPRAY //**

**EXPERTS IN  
SPRAY  
TECHNOLOGY  
SINCE 1937.**

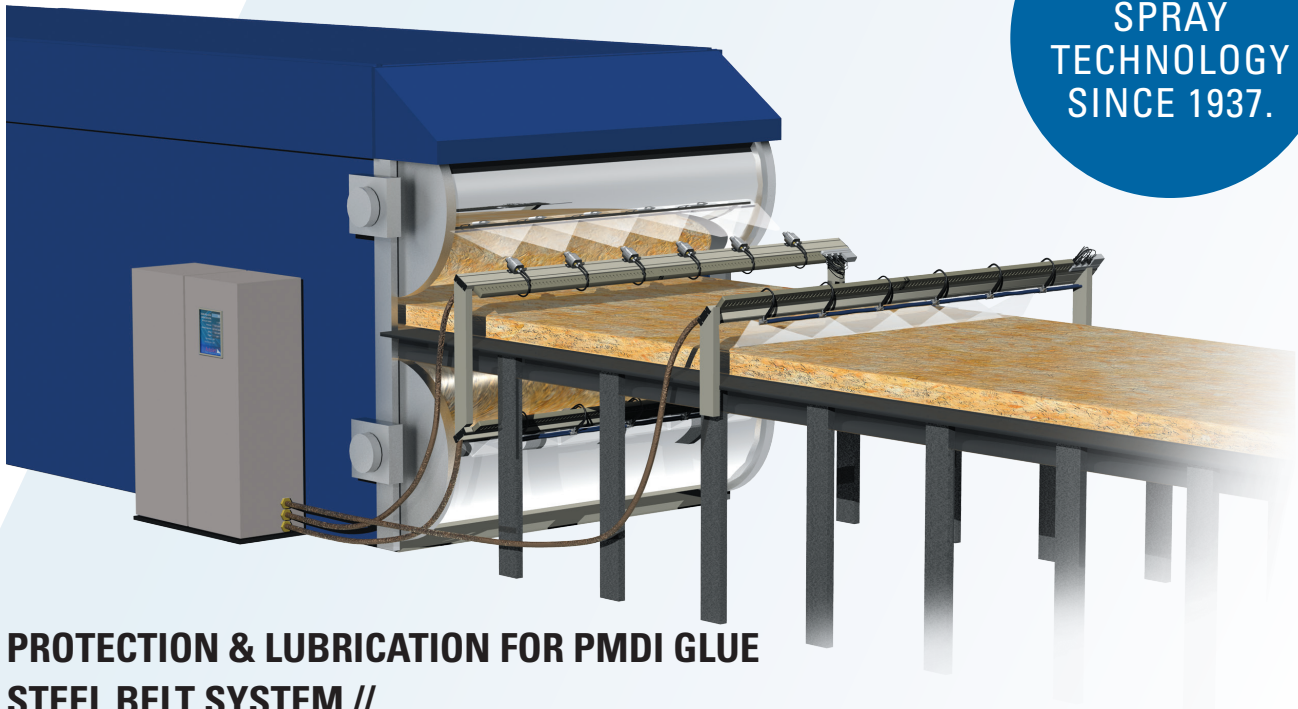

**PROTECTION & LUBRICATION FOR PMDI GLUE  
STEEL BELT SYSTEM //**

**12**

manufacturing  
locations worldwide

**100+**

sales offices

**400+**

active global partners

**ISO**

certificates

**85+**

years in business



**WAX & RESIN APPLICATION  
GLUE SPRAY SYSTEM //**

# OTHER APPLICATION EXAMPLES IN ENGINEERED WOOD //

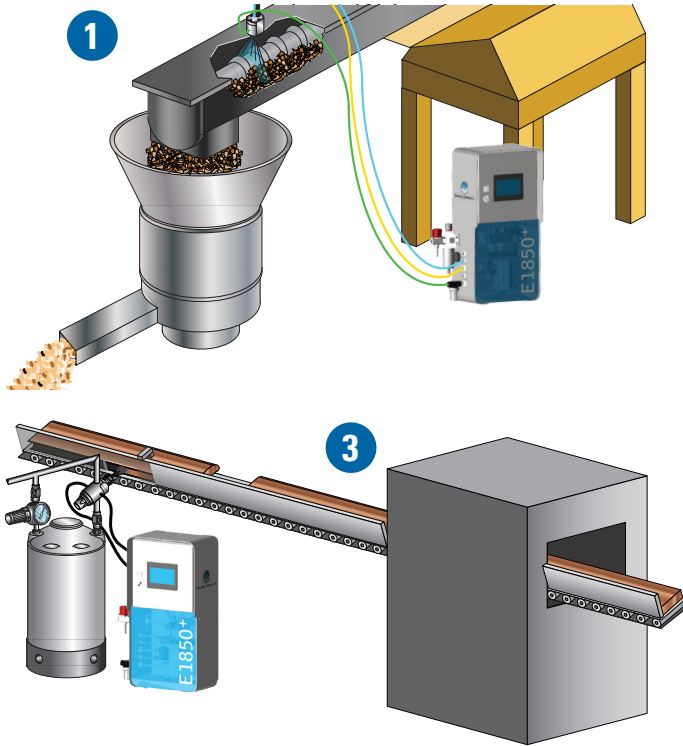

- 1 *Spraying on wood pellets*
- 2 *Gas Cooling System  
NOx Control System  
Nozzles for Wet Filtration System*
- 3 *Biocide protection*

**PRECISION SPRAY CONTROL HELPS TO CREATE MORE SUSTAINABLE BUILDING MATERIALS**

**PROBLEM:** A wood processing facility is looking for an efficient way to apply pigments to wood pellets. The current process is manual and inefficient, leading to inconsistent results and high waste. The manufacturer needs a system that is efficient, consistent, and easy to use. They also need a system that is sustainable and can be used in a large-scale production environment.

**SOLUTION:** The manufacturer installed the CS E4068 Precision Spray Control system. This system allows for precise and consistent application of pigments to wood pellets. The system is easy to use and can be used in a large-scale production environment. The manufacturer is now able to produce high-quality, sustainable building materials.

**CROSS-LAMINATED TIMBER: A STRONG AND SUSTAINABLE BUILDING MATERIAL**

**PROBLEM:** The manufacturer is looking for a way to improve the efficiency of their pigment application process. They need a system that is easy to use and can be used in a large-scale production environment. They also need a system that is sustainable and can be used in a large-scale production environment.

**SOLUTION:** The manufacturer installed the CS E4068 Precision Spray Control system. This system allows for precise and consistent application of pigments to wood pellets. The system is easy to use and can be used in a large-scale production environment. The manufacturer is now able to produce high-quality, sustainable building materials.

**CS E4068 Precision spray control helps to create more sustainable building material**

**HARDWOOD FLOORING MANUFACTURER SAVES € 40,000 PER YEAR BY SPRAYING PIGMENT WITH AUTOJET E1850+ SYSTEM**

**PROBLEM:** A manufacturer of hardwood flooring is looking for a way to improve the efficiency of their pigment application process. They need a system that is easy to use and can be used in a large-scale production environment. They also need a system that is sustainable and can be used in a large-scale production environment.

**SOLUTION:** The manufacturer installed the AutoJet E1850+ system. This system allows for precise and consistent application of pigments to wood pellets. The system is easy to use and can be used in a large-scale production environment. The manufacturer is now able to produce high-quality, sustainable building materials.

**CS E4033 Hardwood flooring manufacturer saves EUR 40k per year by spraying pigment with AutoJet E1850+ system**

**WOOD PELLET MANUFACTURER SAVES MORE THAN € 10,000 PER YEAR BY SPRAYING OIL WITH AUTOMATED SPRAY SYSTEM**

**PROBLEM:** A manufacturer of wood pellets is looking for a way to improve the efficiency of their oil application process. They need a system that is easy to use and can be used in a large-scale production environment. They also need a system that is sustainable and can be used in a large-scale production environment.

**SOLUTION:** The manufacturer installed the CS E4036 Precision Spray Control system. This system allows for precise and consistent application of oil to wood pellets. The system is easy to use and can be used in a large-scale production environment. The manufacturer is now able to produce high-quality, sustainable building materials.

**CS E4036 Wood pellet manufacturer saves more than EUR 10k annually spraying oil with automated spray systems**

**TIMBER PRODUCER TAKES CONTROL OVER MOLD INHIBITOR PROCESS TO SAVE CHEMICALS AND IMPROVE PRODUCT QUALITY**

**PROBLEM:** A timber producer is looking for a way to improve the efficiency of their mold inhibitor application process. They need a system that is easy to use and can be used in a large-scale production environment. They also need a system that is sustainable and can be used in a large-scale production environment.

**SOLUTION:** The timber producer installed the CS E4020 Precision Spray Control system. This system allows for precise and consistent application of mold inhibitors to wood pellets. The system is easy to use and can be used in a large-scale production environment. The timber producer is now able to produce high-quality, sustainable building materials.

**CS E4020 Timber producer takes control over mold inhibitor process to save chemicals and improve product quality**

**LANGUAGE SUPPORT**

[info.uk@spray.com](mailto:info.uk@spray.com) +44 1252 727200 // 
 [info.de@spray.com](mailto:info.de@spray.com) +49 40 766 001 0 // 
 [info.fr@spray.com](mailto:info.fr@spray.com) +33 1 46 20 96 40  
[info.es@spray.com](mailto:info.es@spray.com) +34 91 357 40 20 // 
 [info.it@spray.com](mailto:info.it@spray.com) +39 02 38 34 181 // 
 [info.ae@spray.com](mailto:info.ae@spray.com) +971 4 326 7770  
 We also offer support in Polish / Portuguese / Norwegian / Swedish / Finnish / Romanian / Czech / Greek / Hungarian / Ukrainian  
 Local representatives on [www.spray.com](http://www.spray.com) or contact [Info.EU@spray.com](mailto:Info.EU@spray.com)