

NOTE: APPLY BLUE LOCTITE TO INITIAL  
THREAD UPON INSTALLATION

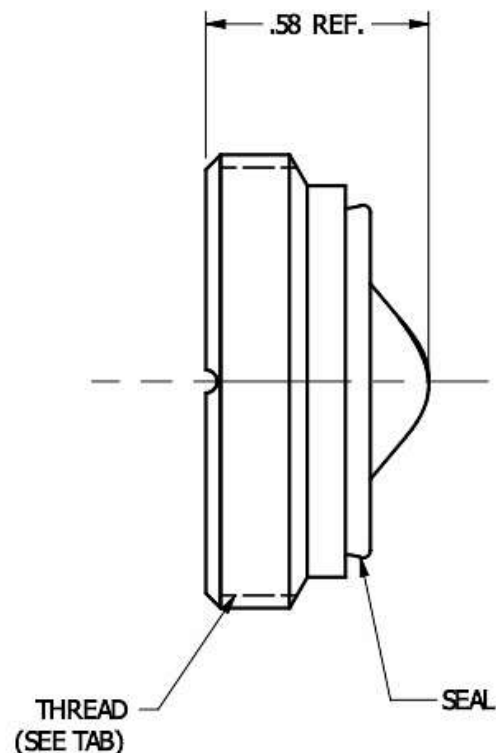

#### INSTALLATION INSTRUCTIONS:

1. THREAD NOZZLE ALL THE WAY INTO THE SHOWER BASE
2. BACK OUT UNTIL GROOVES ARE PARALLEL WITH SHOWER

THE 115680 ONE-PIECE SHOWER NOZZLE IS AVAILABLE IN ANY SPRAY ANGLE OR CAPACITY OF AN EXISTING 27149 NOZZLE, UP TO 60 DEG SPRAY ANGLE. THIS DESIGN TAKES A 3 PIECE DESIGN AND CONSOLIDATES TO ONE-PIECE FOR EASE OF INSTALLATION AND MAINTENANCE.

MATERIAL: TYPE 316 STAINLESS STEEL, HASTELLOY 22HC,  
TITANIUM GRADE 2, OR TITANIUM GRADE 5

PATENT #11,203,032

#### HOW TO ORDER:

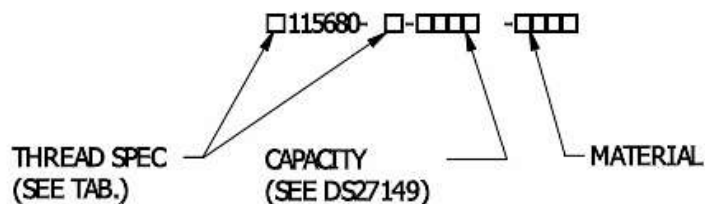

PART NO.	THREAD
115680- - - - -	1-3/16"-18
M115680- - - - -	M30x1.5
M115680-2- - - - -	M32x1.5
115680-2- - - - -	1 1/4"-18
115680-3- - - - -	1 3/8"-12

#### DESCRIPTION:

ONE-PIECE FLAT SPRAY  
SHOWERJET NOZZLE

#\_115680- - - - -



**Spraying Systems Co.**<sup>®</sup>

Spray Nozzles and Accessories  
P.O. Box 7900 - Wheaton, IL 60189-7900

REVISION NO.

1

REFERENCE:

Data Sheet No.

**115680**

SHEET: 1 OF 1

DWG SIZE:

A