

I MOTOR-DRIVEN TANK WASHERS, ACCESSORIES

TANK WASH PRODUCTS

22250



Adjustable three-prong flange
For use with AA090 or
AA190 tank washers

39204

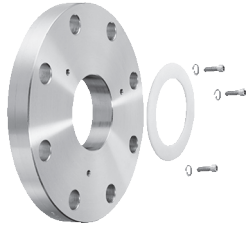

Mounting kit for mounting the
standard AA190 three-prong
flange to a 4" 150# flange
Includes 316 Stainless Steel
raised face flange, lockwasher,
bolts and Teflon® gasket

FEATURES AND BENEFITS

- Adjustable accessories to achieve maximum cleaning efficiencies.
- Adjustable flanges allow maximum cleaning efficiencies by positioning nozzle turret to various spray depths along the length of extension.

OPTIMIZATION TIPS

- See page I2 for optimization tips.

SEE ALSO

- Data Sheets 43047, 43047-1, 22250, 39205, 46395, 45260, 39204 [http://](#)
- Tank Wash Catalog [http://](#)

39205



Adjustable flange with
Tri-Clamp® fitting
2-1/2", 3", 4" and 6" sizes

43047



Ball joint assembly
4" and 6"
Adjust the ball swivel to
change the angle of spray
head as much as 60°

45260



Tank wash adapter for
tanks with 2" to 4" inlet sizes
Celcon® (acetal) with
304 Stainless Steel
screws resists corrosion

46395



Adjustable raised face
flange for tanks with
150# flange connections
2", 3" and 4" sizes

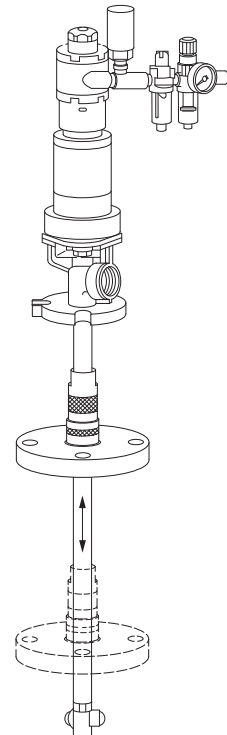

Adjustable flanges can be positioned
anywhere on the shaft.

